

Installation Guide for IBM-Compatible PCs

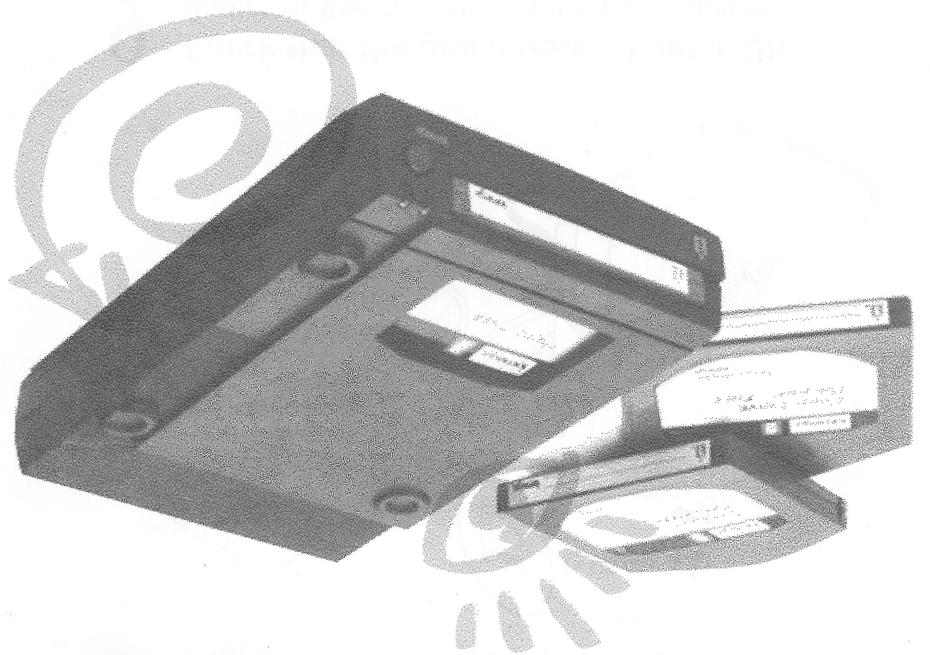

111-B Telok Ayer St.
Singapore 068580
Tel : 65-2227 225
Fax : 65-2227 119

Omega Pacific Pte Ltd

Internet Home Page: <http://www.omega.com>
America Online™: Keyword: Omega
Microsoft Network: GoWord: Omega
Interactive Voice Response Unit: 1-801-629-7629
Technical Support E-Mail: support@omega.com
(Please type "Jaz" in the subject header when sending your E-Mail)
Omega Bulletin Board: 1-801-778-5888
8, N, 1; 9600 baud and above; ANSI (24 hrs - Download only)

Omega's Automated Help Systems

The Radio Interference Regulations of the Canadian Department of Communications.

Canadian DOC Information

This digital apparatus does not exceed the Class B limits for radio noise emissions from digital devices as set out in the Radio Interference Regulations of the Canadian Department of Communications.

WARNING Only the manufacturer's cable or an equivalent double shielded, host interface cable should be used with external subsystems. Other types of cables may violate FCC rules and regulations. Also, changes or modifications to the electronics or enclosure of this product must be expressly approved by Omega; otherwise, the user's authority to operate the equipment may be voided by the FCC.

WARNING Plug the computer and its peripherals into a different branch from that used by the affected device.

• Increase the distance between the affected device and the computer equipment.
• Reorient the affected device and/or its receiving antenna.
• Turn off the computer and its peripherals when not in use.

The user may be able to eliminate any interference by implementing one or more of the following measures:

• Turn off the computer and its peripherals when not in use.
• Turn off the computer and its peripherals when not in use.
• Turn off the computer and its peripherals when not in use.

Part 15, Class B, of the FCC Rules, is designed to provide reasonable protection against radio and television interference in a residential installation. Although the equipment has been tested and found to comply with allowed RF emission limits, as specified in the above cited Rules, there is no guarantee that interference will not occur in a particular situation. Interference can be determined by turning the equipment off and on while monitoring radio or television reception. If the interference appears to be caused by the equipment, the user should take the following measures:

• Turn off the computer and its peripherals when not in use.
• Turn off the computer and its peripherals when not in use.

Interference This equipment complies with Part 15 of the FCC Rules and its operation is subject to the following conditions: (1) the equipment may not cause harmful interference, and (2) the equipment must accept any interference received, including interference that may cause undesired operation.

The computer equipment described in this installation guide generates and uses radio frequency (RF) energy. If the equipment is not installed and operated in strict accordance with the manufacturer's instructions, interference to radio and television reception may result.

United States FCC Information

Installation Guide

1 Check your SCSI (Small Computer System Interface) connection.

The instructions in this guide show how to install your Jaz drive on an external SCSI connection.



- If you plan to use an Omega SCSI adapter, install it NOW using the installation guide shipped with the adapter; then return to step 2 below. If you need to purchase an adapter, call your Omega dealer.
- If you plan to use a non-Omega SCSI adapter, refer to "Non-Omega SCSI Adapters" in the Jaz User's Guide.

Windows NT Users You may need to install driver software for your SCSI adapter. Refer to NTRadme.txt on the Windows NT Install diskette for additional information.

2 Unpack the Jaz drive and accessories.

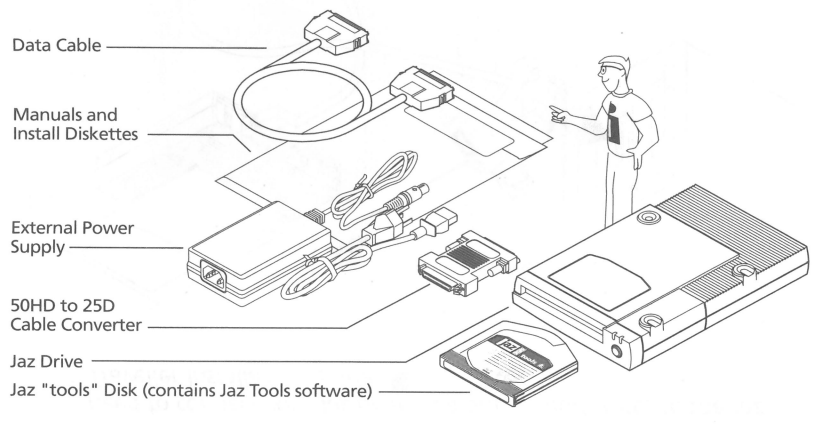

Jaz Tools Software The Jaz "tools" disk includes software packages for systems running Windows 95, Windows NT, Windows 3.x, or DOS. For systems running OS/2, you can purchase a separate Omega Driver and Tools package that provides full support for Jaz drive under OS/2.

3 Turn OFF the computer power switch, and pick up the Jaz data cable.

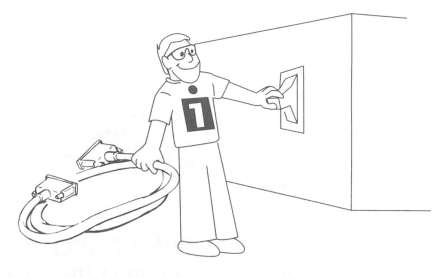

WARNING Always turn off power to the computer and all devices connected to it (such as printers or drives) before beginning any computer hardware change.

4 Connect one end of the data cable to either SCSI port on the back of your drive, and PUSH until connector locks into place. (If the connector doesn't seem to fit, try turning it over.)

CAUTION DO NOT attempt to stand the Jaz drive on its side! NEVER move the drive while in use!

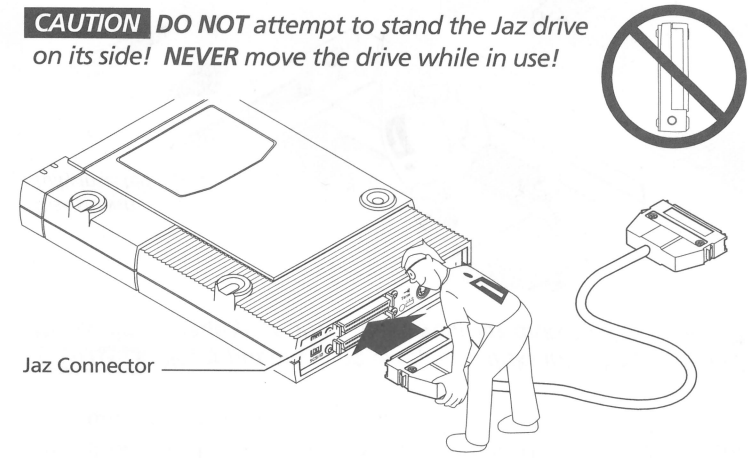

To Remove the Jaz Data Cable: Squeeze the spring locks on both sides of the data cable connector while pulling on the connector.

(Open up for Step 5)

5 Connect the other end of the data cable to the SCSI connection on your computer.

CAUTION Unless you are using Jaz Traveller, always make sure you connect the Jaz drive to a SCSI connector and NOT to a printer port (which is the same size and shape as a 25 pin SCSI connector). If you need to connect your Jaz drive to a printer port, refer to the Jaz Traveller Installation Guide. ■

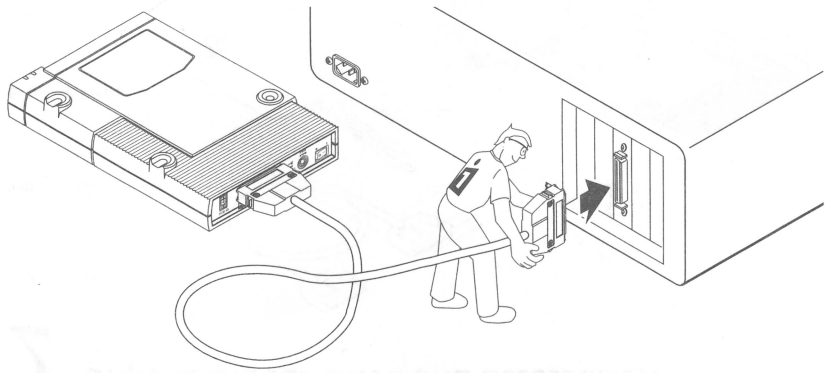

50HD to 25D Cable Converter

Use the 50HD to 25D cable converter if you need to connect your Jaz drive to a 25 pin SCSI connector.

Jaz Data Cable Connector

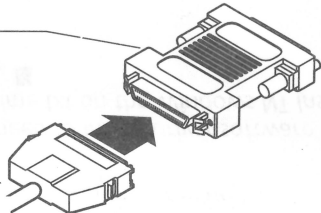

6 OPTIONAL: You can connect other SCSI drives to the Jaz drive using another SCSI cable (usually a high density 50 pin to 50 pin cable).



To Computer or Previous SCSI Device

To Another SCSI Device

7 Check SCSI ID's if you have a SCSI chain.

Each device in the SCSI chain must have a unique SCSI ID. If you have no other devices, the factory setting of SCSI ID 4 should work. If you need additional information, refer to "SCSI Guidelines" in your Jaz User's Guide.

■ **SCSI Termination** Your Jaz drive is set to handle SCSI termination automatically. Refer to the Jaz User's Guide if you need additional information. ■

8 Connect the external power supply and turn on the power switch.

CAUTION Use only an approved Iomega Jaz power supply. Other power supplies may damage your Jaz drive. ■

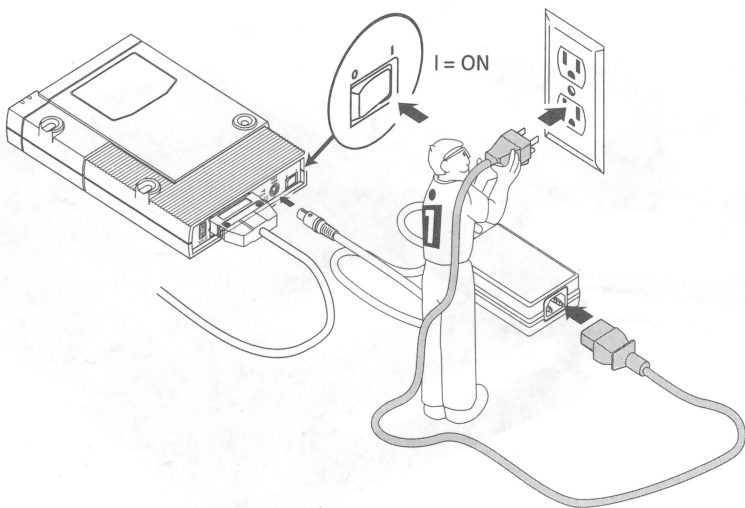

9 Check that the green power light is ON. (Indicates that the power supply is connected properly.)

Green Power Light
Amber Data Light
(Flashes when drive is busy)

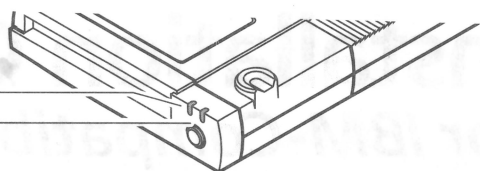

10 Turn your computer ON and gently insert the 1GB "tools" disk into your Jaz drive.

The amber data light on the Jaz drive flashes as the disk spins up and glows steadily while it acquires. When the amber data light goes out, the drive is ready to use.

CAUTION Never put anything except Jaz disks into the Jaz drive as this could damage your drive. Keep your Jaz disks free of debris. ■

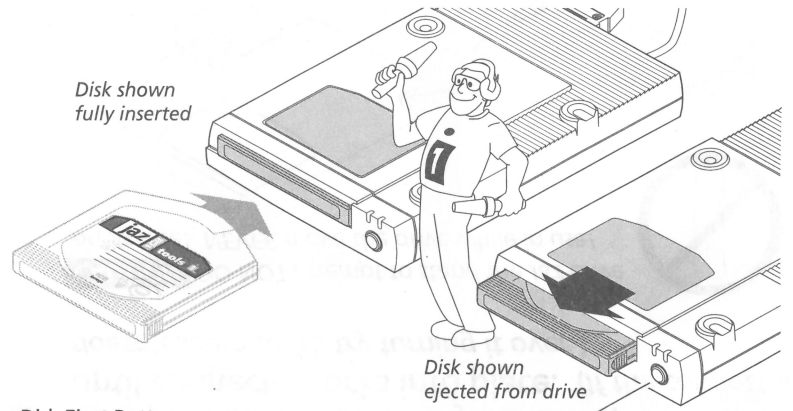

Disk shown fully inserted

Disk shown ejected from drive

Disk Eject Button

■ **Ejecting Jaz Disks** After you push the disk eject button, the drive takes a few seconds to spin down and eject the disk. ■

11 Insert the Install diskette for your system into your computer's floppy drive.

Use Disk 1 if your computer is running Windows 95, Windows 3.1, or DOS. Use Disk 2 if your computer is running Windows NT.

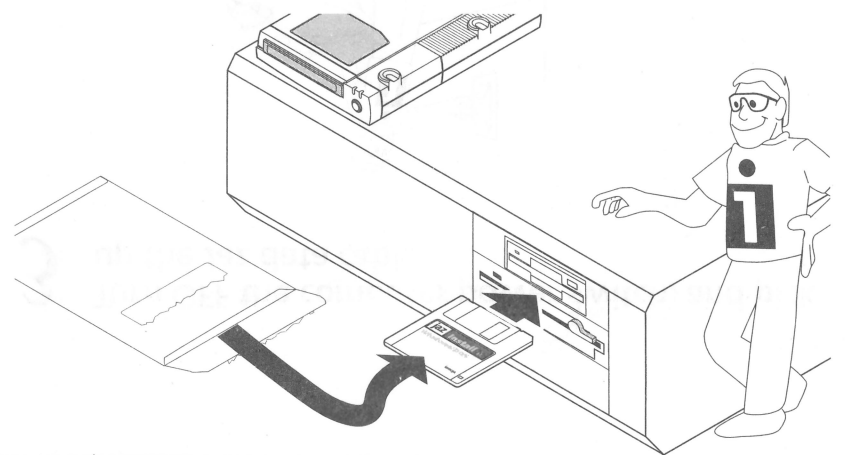

12 Start the Setup program as described below and follow the screen instructions to install your Jaz Tools software.

Windows 95 Users: Open *My Computer* and double click on the floppy drive icon to open a window for Install Disk 1. Double click on the **Setup** icon to install Tools 95 on your system.

Windows NT Users: Run **SetupNT** from Install Disk 2 to install your ToolsNT software package.

Windows 3.1 Users: Start Windows. In the Windows Program Manager, select the File menu and choose **Run**. In the Command Line box, type **a:setup** if Install Disk 1 is in drive a: (or **b:setup** if it is in drive b:), then click **OK** or press the Enter key.

DOS Users: Run **GUEST.EXE** from the DOS prompt for Install Disk 1, then run **INSTALL.EXE** from the **DOSSTUFF** directory on the Jaz "tools" disk. After the software installation is complete, run **RECLAIM.EXE** from the **DOSSTUFF** directory. If you need detailed instructions, refer to **MANUAL.EXE** on Install Disk 1.



If you need help, refer to "Troubleshooting" in the Jaz User's Guide. The electronic manual (**MANUAL.EXE**) located on Install Disk 1 also includes problem solving information for software installations under Windows 95, Windows 3.1, and DOS.

■ **IMPORTANT!** Your 1GB Jaz "tools" disk contains installation files for your Jaz Tools software. Avoid deleting the installation files for your system in case you need to reinstall your software. ■



Congratulations! When the software installation is complete, your Jaz drive will be ready to use.

Use your Jaz drive just like any other drive on your system. Your Jaz drive will have its own drive letter, and you can store and copy files to and from the Jaz drive using the same methods you use for your other drives. For more information about using your new drive and Jaz Tools software, refer to the Jaz User's Guide.

⌚ If you want to use your Jaz drive on a Macintosh as well as your PC: Refer to the **GUESTHLP.TXT** file on the Windows/DOS Install diskette for information on accessing your Jaz drive temporarily on a Macintosh.