

# HP F1435A Auto/Airline Power Adapter

The auto/airline power adapter is designed to work with an airline's inflight power system, as well as in a standard cigarette lighter socket, as found in most automobiles, RVs and boats. An inflight power system is currently available on most of the major airlines. Consult with the airline to confirm its availability on your flights.

**Caution:** Use this adapter only with the HP OmniBook Sojourn and the F1433A Multimedia Expansion Slice. Do not use an adapter from another product. Using an improper adapter could damage the OmniBook and void your warranty.

## To connect the auto/airline adapter

- 1 Connect the adapter cord to the back of the OmniBook or multimedia expansion slice.
- 2
  - **For automobile use:** Insert the cigarette lighter adapter into the car's cigarette lighter socket.
  - **For airline use:** Press the latch on the airline connector and remove the cigarette lighter adapter. Insert the exposed airline connector into the inflight power socket in the airline seat.

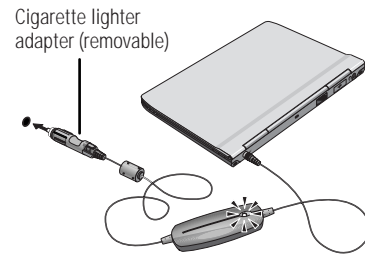

Connecting to a cigarette lighter adapter

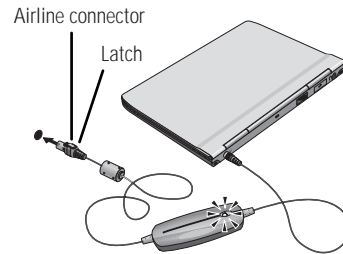

Connecting to inflight power

- 3 The green indicator light on the adapter shines when the adapter is receiving power.

## Operating Guidelines

- **For automobile use:** Some vehicles are designed with power constantly supplied to the cigarette lighter, even when the ignition is off. Some vehicles disconnect power from the cigarette lighter socket when the engine is started. If you encounter problems with the OmniBook when starting the engine, disconnect the adapter from the OmniBook before starting the engine.
- **For airline use:** The inflight power system is controlled by the cabin crew. After the power system is turned on, a light on the seat socket will shine.

# Battery Safety

- To avoid risk of fire, burns, or damage to your battery slice, do not allow a metal object to touch the battery contacts on the battery slice, which could cause shorting.
- These batteries are suitable for use only with the HP OmniBook Sojourn. Check the *Support and Service* booklet for your local HP contact.
- Do not let a battery get moist or wet, which could cause shorting.
- Do not disassemble the battery slice. There are no serviceable parts inside.
- Handle a damaged or leaking battery with extreme care. If you come in contact with the electrolyte, wash the exposed area with soap and water. If it contacts the eye, flush the eye with water for 15 minutes and seek medical attention.
- When discarding a battery, contact your local waste disposal provider regarding local restrictions on the disposal or recycling of batteries. Cover the exposed battery terminals with electrician's tape before disposing of the battery. Do not dispose of a battery in fire or water.
- To obtain a replacement battery, contact your local dealer, HP sales office, or the HP website.
- Do not expose the battery to temperatures above 60 °C (140 °F) or below -20 °C (-4 °F).
- Do not use the battery in ambient temperatures above 35 °C (95 °F) or below 5 °C (41 °F). Do not use it in direct sunlight, near a heating source, or in relative humidity above 80% or below 20%.

## European Declaration of Conformity (according to ISO/IEC Guide 22 and EN 45014)

Products sold in Europe by Hewlett-Packard and its authorized dealers meet the specifications listed below.

**Manufacturer:** Hewlett-Packard Company  
**Address:** Hewlett-Packard Company  
Mobile Computing Division  
19310 Pruneridge Ave.  
Cupertino, CA 95014

**Product Names:** HP OmniBook Multimedia Expansion Slice, HP OmniBook Enhanced Battery Slice, HP OmniBook AC Adapter, HP OmniBook Auto/Airline Power Adapter  
**Model Numbers:** HP F1431A, HP F1433A, HP F1434A, HP F1435A  
**Options:** All

declares that the following products:  
conforms to the following product specifications  
**Safety:** IEC 950:1991+A1,A2 / EN 60950 (1992)+A1,A2; IEC 825-1:1993/EN60825-1:1994, Class 1  
**EMC:** EN 50082-1:1992  
CISPR 22:1993 / EN 55022 (1994); Class B <sup>(1)</sup>  
IEC 801-2:1991 / prEN 55024-2 (1992); 4kV CD, 8kV AD  
IEC 801-3:1984 / prEN 55024-3 (1991); 3V/m  
IEC 801-4:1988 / prEN 55024-4 (1992); 0.5 kV signal lines, 1.0kV power lines  
<sup>(1)</sup>The product was tested in a typical configuration with Hewlett-Packard personal computer peripherals.

**Supplementary Information:** The product herewith complies with the requirements of the Low Voltage Directive 73/23/EEC and the EMC Directive 89/336/EEC and carries the CE mark accordingly. The HP F1434A ac adapter used with this product is designed to operate on all power systems, other than IT power systems.

Quality Department  
Hewlett-Packard Company  
Mobile Computing Division



Part Number (P) 1430-90004 Edition 1



Printed in U.S.A.



1 2 3 4 5 6 7 8 9 10 11 12  
• 94 95 96 97 98 99 •



## HP OmniBook Sojourn Accessories

- Multimedia Expansion Slice
- Enhanced Battery Slice
- AC Adapter
- Auto/Airline Power Adapter

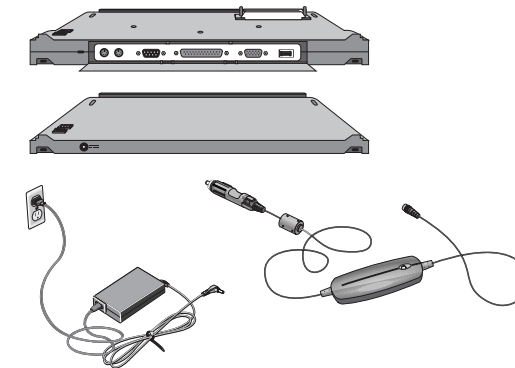

## Instructions

# OMNIBOOK

## HP F1431A Multimedia Expansion Slice and HP F1433A Enhanced Battery Slice

The Enhanced Battery Slice extends the battery life of the OmniBook. The OmniBook will use power from the battery slice first, then from the internal battery.

The multimedia expansion slice and the battery slice are connected to the OmniBook in the same way.

### To connect an expansion slice or a battery slice

- You can connect both an expansion slice and a battery slice to the OmniBook at the same time. If you do so, connect the expansion slice first (beneath the OmniBook), then the battery slice beneath the expansion slice.
- You can connect only one battery slice.

**1 Important:** From the Start menu, Shut down or Suspend the computer before connecting or removing a slice.

**2** Close the display and turn over the OmniBook.

**3** Slide open the connector covers on the bottom of the computer. **Note:** For the battery slice, open just the battery cover.

**Caution:** If you do not connect a slice to the computer, do not leave the connector covers open.

**4** Align the catch on the slice to the slot on the rear of the computer. Slide the computer backward.

**5** Push the front part of the computer until it clicks. Avoid excessive pressure to the display.

**6** Charge the battery slice before using it the first time. (See next page.)

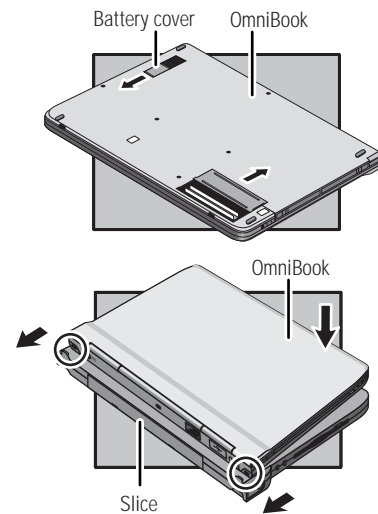

### To remove a slice

**1 Important:** From the Start menu, Shut down or Suspend the OmniBook. Close the display.

**2** Slide the latch(es) on the front part of the slice as shown. (The battery slice has two latches.) You can now remove the computer from the slice.

**3** Close the connector covers on the bottom of the computer.

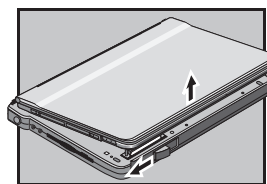

## HP F1433A Enhanced Battery Slice

### To charge a battery slice

**Caution:** Use only the HP F1434A adapter. Using another adapter could damage your OmniBook and void the warranty.

You can recharge a battery slice either connected to the computer or disconnected from it.

**1** Connect the power cord to the ac adapter and plug the power cord into an outlet.

**2** • **If the battery slice is connected to the computer:** Connect the ac adapter to the computer.

This recharges the internal battery first, then the battery slice. (The internal battery takes 2 to 10 hours to recharge, depending on whether the computer is in use or not.)

**Important:** Do not connect the ac adapter to the battery slice when the battery slice is also connected to the computer or to the multimedia expansion slice. No charging will result!

• **If the battery slice is *not* connected to the computer:** Connect the ac adapter directly to the battery slice, as shown.

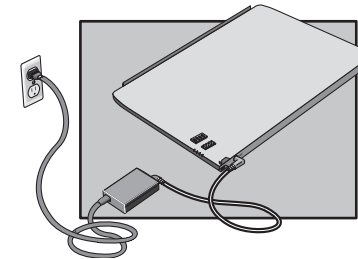

• The battery slice provides up to an additional 4.5 hours of power.

• The battery slice discharges *first*, then the internal battery discharges.

| Charging Method:<br>AC connected to | Charging Time  |
|-------------------------------------|----------------|
| OmniBook (turned off)               | 6-9 hours      |
| OmniBook (turned on)                | 24 to 27 hours |
| Battery Slice                       | 5 hours        |

### To check the charging status

• The green status lights on the battery slice indicate charge level to the nearest 25%. Press the battery status button to see how many lights (one to four) turn on.

• The orange status light indicates the battery slice is charging.

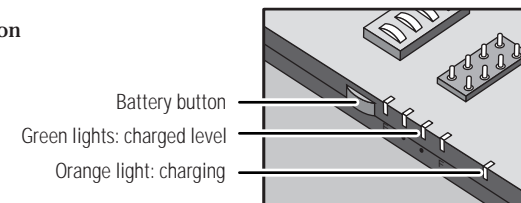

## HP F1434A AC Adapter

**Caution:** Use this adapter only with the HP OmniBook Sojourn and the F1433A Enhanced Battery Slice. Do not use an adapter from another product. Using an improper adapter could damage the OmniBook and will make your warranty invalid.

### To connect the ac adapter

**1** Connect the power cord to the ac adapter.

**2** Plug the ac adapter cord into an ac outlet.

**3** Connect the ac adapter to the OmniBook's ac adapter port, as shown.

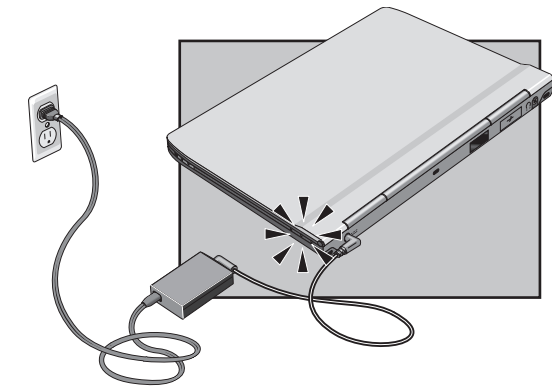

### Operating Guidelines

For best performance, disconnect the adapter from the OmniBook or expansion slice before unplugging it from the power source.

- If you will not be using the adapter for an extended period of time, unplug it from the power source.
- Do not attempt to repair the adapter. There are no serviceable parts inside.
- For warranty and service information, see the *Support and Service* booklet shipped with your OmniBook.
- Observe these environmental limits: 5 to 35 °C (41 to 95 °F) and 20 to 80% relative humidity (non-condensing).